

The MENDON

2,156 Square Feet ♦ 3 Bedrooms ♦ 2 Baths

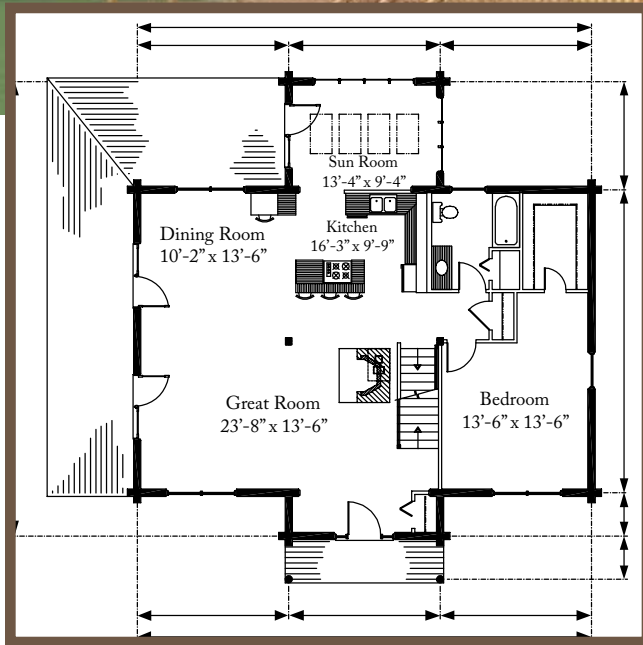

First Floor

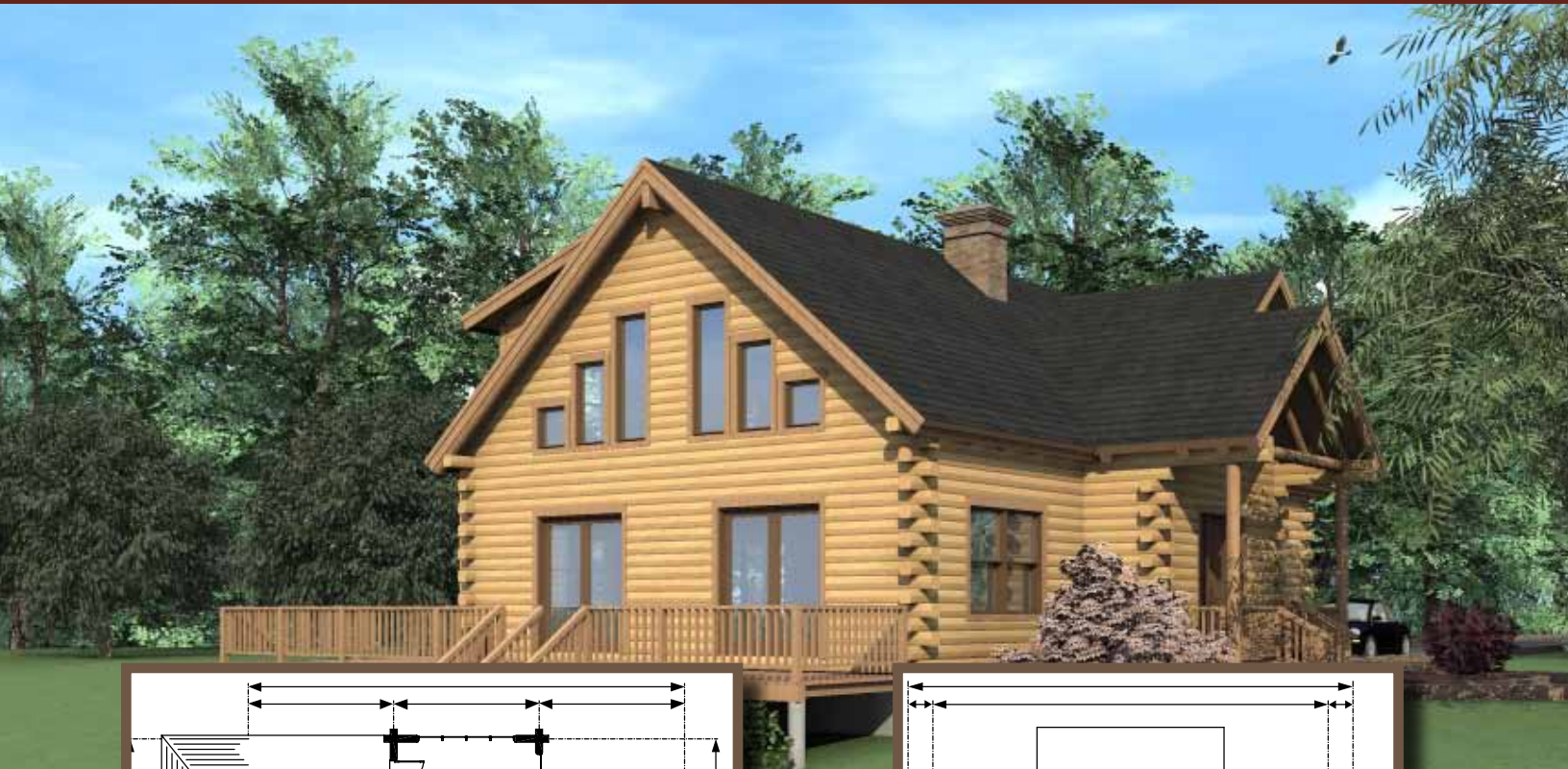
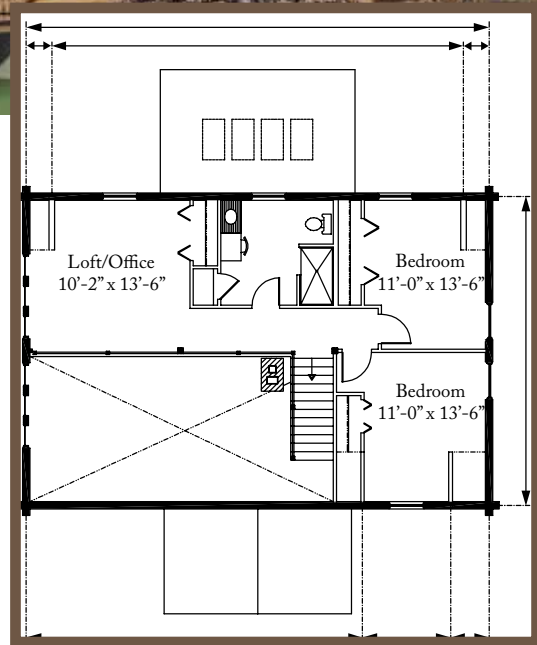

Second Floor



So nice to come home to™

For more information, please call:

800-REAL-LOG

or visit:

www.realloghomes.com

REAL LOG HOMES®

Standard Package Components

- Pre-cut solid log walls and gable ends (Per Plan)
Featuring our Interlock™ Log Joinery System Including:
FastenMaster® OlyLog® or LogHog® Fasteners, PVC Lock-spline™, Norton Log Home Foam™, Sashco® Log Builder Caulk, Foam Blocks and Pre-Installed Corrugated Fasteners, Special Milled Framestock
- Andersen® 400 Series Windows and Patio Doors
With:
Rigid Vinyl Exterior, High Performance (Low-E) Glass, Screens, Stone Hardware, and Natural Clear Pine Interior
- Therma-Tru® Fiber-Classic Doors
- Log Siding Skirtboard
- Pre-Cut Log or Timber Joists Including Pre-Notching Log Wall (Per Plan)
- Pre-Cut and Notched Heavy Timber Girders (Per Plan)
- Pre-Cut Log or Timber Rafters (Per Plan)
- Glu-Laminated Ridge Beams (Per Plan)
- Log or Timber Support Posts & Settling Screw-jacks as Required
- Porches:
Log Posts, Pre-Cut Log Porch Plates and Pre-cut Log or Timber Rafters
- Tim-Bor®, an EPA-Registered, Non-Toxic Wood Preservative
- 3 Sets of Blueprints with Assembly Details
- Pre-Cut Log Wall Assembly Instructions
- Complete List of Materials Included in the Package
- Fully Illustrated Construction Manual
- Four Hours of Complimentary Technical Assistance

The standard package components may vary depending on the features of a particular home. Contact us or your Independent Representative for more details and our extensive list of options.



So nice to come home to™

For more information call:

800-REAL-LOG

or visit:

www.realloghomes.com